



## TEMPLE CLOSE

LONDON, N3 3SB

£2,100 PER MONTH

A modern two double bedroom 2nd floor apartment with L shaped reception, family bathroom, fitted kitchen and it has been recently refurbished. the property is close to Finchley Central tube station and all the local shops and cafes. Offered unfurnished, Council Tax Band D. Available from 19 July, 2025.

**david harris & co**

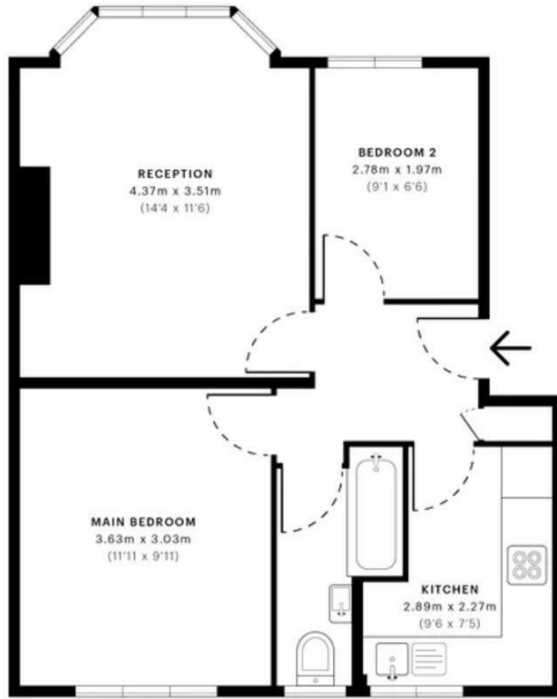

— First Floor



Energy Efficiency Rating		
	Current	Potential
Very energy efficient - lower running costs		
(92 plus) <b>A</b>		
(81-91) <b>B</b>		
(69-80) <b>C</b>		
(55-68) <b>D</b>	65	67
(39-54) <b>E</b>		
(21-38) <b>F</b>		
(1-20) <b>G</b>		
Not energy efficient - higher running costs		
<b>England &amp; Wales</b>	EU Directive 2002/91/EC	

Agents Note: Whilst every care has been taken to prepare these particulars, they are for guidance purposes only. All measurements are approximate and are for general guidance purposes only and whilst every care has been taken to ensure their accuracy, they should not be relied upon and potential buyers/tenants are advised to recheck the measurements

Finchley Lettings  
358 Regents Park Road  
Finchley  
London  
N3 2LJ

020 8346 9122  
info@davidharris.co.uk  
www.davidharris.co.uk

**david harris & co**